

## Flat Knurled Nuts • DIN 467 EH 24760.



### Product Description

Knurled nuts are very versatile. Three material versions for the different requirements

- Steel, blackened
  - Steel, zinc-plated by galvanization
  - Stainless steel
- are available.

Knurled nuts can be easily tightened and released by hand. The ribbed outer surface of the nut prevents slipping when tightening / releasing with the fingers. The flat knurled nuts are manufactured according to DIN 467.

### Material

- Steel, blackened, quality 5
- Steel, zinc-plated by galvanization, quality 5
- Stainless steel 1.4305, dull blasted

### More information

#### Notes

Knurling pitch and knurling depth may differ from DIN.

#### Further products

- High Knurled Nuts, DIN 466

### Drawing

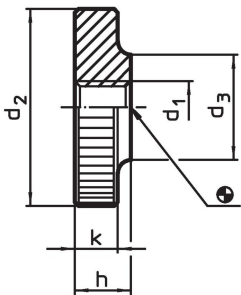

### Order information

d <sub>1</sub>	d <sub>2</sub>	Dimensions			[g]	Art. No.
		d <sub>3</sub> [mm]	h	k		
<b>Steel, blackened</b>						
M 3	12	6	3	2.5	2.1	<a href="#">24760.0030</a>
M 4	16	8	4	3.5	5.1	<a href="#">24760.0040</a>
M 5	20	10	5	4.0	9.4	<a href="#">24760.0050</a>
M 6	24	12	6	5.0	17.0	<a href="#">24760.0060</a>
M 8	30	16	8	6.0	32.0	<a href="#">24760.0080</a>
M10	36	20	10	8.0	61.0	<a href="#">24760.0100</a>
M12	40	22	12	10.0	92.0	<a href="#">24760.0120<sup>1)</sup></a>
<b>Steel, zinc-plated by galvanization</b>						
M 3	12	6	3	2.5	2.0	<a href="#">24760.0430</a>
M 4	16	8	4	3.5	5.0	<a href="#">24760.0440</a>
M 5	20	10	5	4.0	9.0	<a href="#">24760.0450</a>
M 6	24	12	6	5.0	17.0	<a href="#">24760.0460</a>
M 8	30	16	8	6.0	32.0	<a href="#">24760.0480</a>
M10	36	20	10	8.0	62.0	<a href="#">24760.0500</a>
M12	40	22	12	10.0	92.0	<a href="#">24760.0512<sup>1)</sup></a>

<sup>1)</sup> DIN standards do not include these dimensions.

d <sub>1</sub>	d <sub>2</sub>	Dimensions			k	[g]	Art. No.
		d <sub>3</sub> [mm]	h				
<b>Stainless steel 1.4305</b>							
M 3	12	6	3	2.5	2.1	<a href="#">24760.0230</a>	
M 4	16	8	4	3.5	5.1	<a href="#">24760.0240</a>	
M 5	20	10	5	4.0	9.4	<a href="#">24760.0250</a>	
M 6	24	12	6	5.0	17.0	<a href="#">24760.0260</a>	
M 8	30	16	8	6.0	32.0	<a href="#">24760.0280</a>	
M10	36	20	10	8.0	61.0	<a href="#">24760.0300</a>	

<sup>1)</sup> DIN standards do not include these dimensions.

### Application example

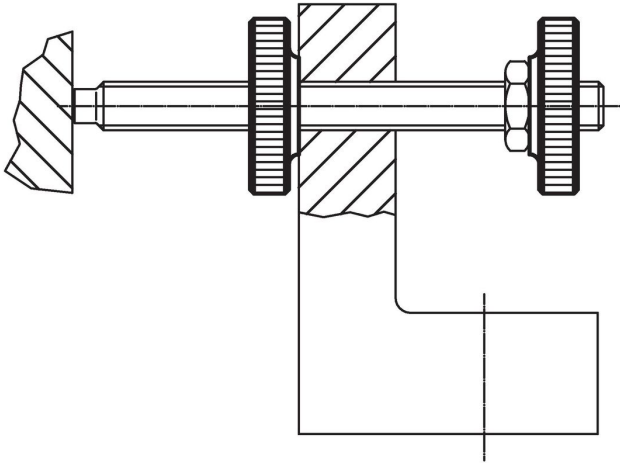

### Compliance

For detailed compliance information please select the desired article number.