

Star Grips • DIN 6336 light metal  
EH 24660.



**Product Description**

These star grips are manufactured according to DIN 6336.

**Material**

**Handle**

- Light metal Al, unpolished
- Light metal Al, polished

**Drawing**

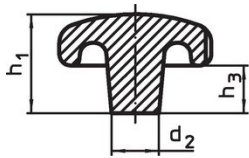

picture 1

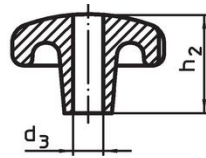

picture 2

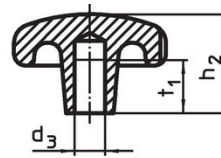

picture 3

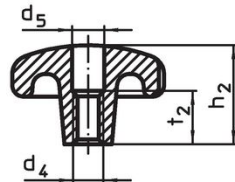
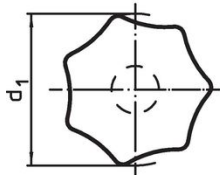

picture 4

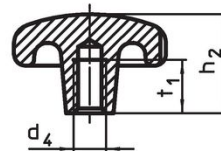

picture 5

**Order information**

Dimensions											Art. No.
d <sub>1</sub>	d <sub>2</sub>	d <sub>3</sub> H7	d <sub>4</sub>	d <sub>5</sub> [mm]	h <sub>1</sub>	h <sub>2</sub>	h <sub>3</sub>	t <sub>1</sub> min.	t <sub>2</sub>	[g]	
<b>raw part, form A – picture 1, unpolished</b>											
40	14	–	–	–	26	–	13	–	–	36	<a href="#">24660.0040</a>
50	18	–	–	–	34	–	17	–	–	70	<a href="#">24660.0050</a>
63	20	–	–	–	42	–	21	–	–	128	<a href="#">24660.0063</a>
80	25	–	–	–	52	–	25	–	–	245	<a href="#">24660.0080</a>
<b>with smooth blind hole, form C – picture 3, unpolished</b>											
40	14	8	–	–	–	25	–	15	–	30	<a href="#">24660.0240</a>
50	18	10	–	–	–	32	–	18	–	63	<a href="#">24660.0250</a>
63	20	12	–	–	–	40	–	22	–	117	<a href="#">24660.0263</a>
80	25	16	–	–	–	50	–	28	–	223	<a href="#">24660.0280</a>
<b>with thread, drilled out, form D – picture 4, unpolished</b>											
40	14	–	M 8	8.4	–	25	–	–	13	32	<a href="#">24660.0340</a>
50	18	–	M10	10.5	–	32	–	–	16	62	<a href="#">24660.0350</a>
63	20	–	M12	13.0	–	40	–	–	20	109	<a href="#">24660.0363</a>
80	25	–	M16	17.0	–	50	–	–	20	218	<a href="#">24660.0380</a>
<b>with threaded blind hole, form E – picture 5, unpolished</b>											
40	14	–	M 8	–	–	25	–	15	–	33	<a href="#">24660.0440</a>
50	18	–	M10	–	–	32	–	18	–	63	<a href="#">24660.0450</a>
63	20	–	M12	–	–	40	–	22	–	118	<a href="#">24660.0463</a>
80	25	–	M16	–	–	50	–	28	–	227	<a href="#">24660.0480</a>

d <sub>1</sub>	d <sub>2</sub>	d <sub>3</sub> H7	d <sub>4</sub>	Dimensions						[g]	Art. No.
				d <sub>5</sub> [mm]	h <sub>1</sub>	h <sub>2</sub>	h <sub>3</sub>	t <sub>1</sub> min.	t <sub>2</sub>		
<b>with smooth blind hole, form C – picture 3, polished</b>											
40	14	8	–	–	–	25	–	15	–	30	24660.0640
50	18	10	–	–	–	32	–	18	–	63	24660.0650
63	20	12	–	–	–	40	–	22	–	117	24660.0663
80	25	16	–	–	–	50	–	28	–	223	24660.0680
<b>with thread, drilled out, form D – picture 4, polished</b>											
40	14	–	M 8	8.4	–	25	–	–	13	32	24660.0740
50	18	–	M10	10.5	–	32	–	–	16	62	24660.0750
63	20	–	M12	13.0	–	40	–	–	20	109	24660.0763
80	25	–	M16	17.0	–	50	–	–	20	218	24660.0780
<b>with threaded blind hole, form E – picture 5, polished</b>											
40	14	–	M 8	–	–	25	–	15	–	33	24660.0840
50	18	–	M10	–	–	32	–	18	–	63	24660.0850
63	20	–	M12	–	–	40	–	22	–	118	24660.0863
80	25	–	M16	–	–	50	–	28	–	227	24660.0880

## Compliance

### RoHS compliant

Contains lead - compliant according to exceptions 6a / 6b / 6c.

### Contains SVHC substances >0,1% w/w

Contains lead - SVHC list [REACH] as of 27.06.2024.

### Contains Proposition 65 substances



Lead can cause cancer and reproductive harm from exposure  
<https://www.P65Warnings.ca.gov/>

### Free from Conflict Minerals

This product does not contain any substances designated as "conflict minerals" such as tantalum, tin, gold or tungsten from the Democratic Republic of Congo or adjacent countries.