

## Stop Plates for Taper Clamping Units • for clamping bars

EH 23250.



### Product Description

The stop plate is used when clamping only on one side of the taper clamping unit. One side of the taper clamping unit rests against the step of the stop plate and is thus fixed.

### Material

- Tool steel, hardened

### Assembly

The stop plate is mounted between the clamping bar and the taper clamping unit.

### Drawing

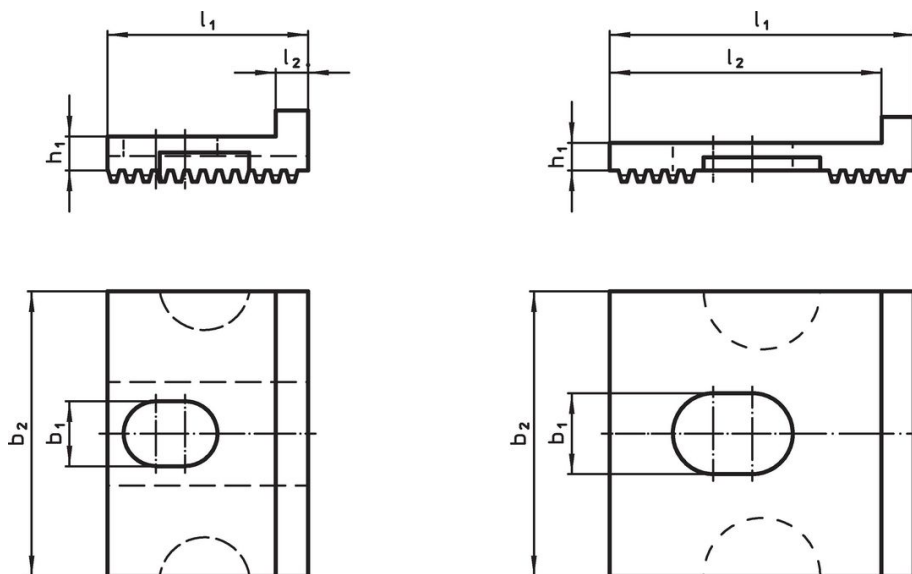

picture 1

picture 2

### Order information

l <sub>1</sub>	l <sub>2</sub>	Dimensions			for taper clamping units	[g]	Art. No.
		b <sub>1</sub>	b <sub>2</sub>	h <sub>1</sub>			
[mm]							
<b>picture 1</b>							
31	5	10.0	44	6.4	23250.0501 - .0503	61	23250.0540
<b>picture 2</b>							
47	42	12.5	44	4.4	23250.0510 - .0515	60	23250.0541

### Compliance

#### RoHS compliant

Compliant according to Directive 2011/65/EU and Directive 2015/863.

#### Does not contain SVHC substances

No SVHC substances with more than 0.1% w/w contained - SVHC list [REACH] as of 23.01.2024.

#### Does not contain Proposition 65 substances

No Proposition 65 substances included.  
<https://www.P65Warnings.ca.gov/>

#### Free from Conflict Minerals

This product does not contain any substances designated as "conflict minerals" such as tantalum, tin, gold or tungsten from the Democratic Republic of Congo or adjacent countries.