

## Spacers

EH 1617.400 - EH 1617.900



### Product Description

For the L-12 hole and dowel system the disks 1107.400 - 1108.300 are used.

### Material

- Steel, case-hardened, ground

### Drawing

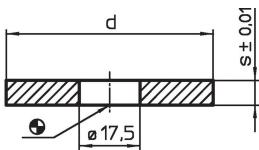

### Order information

System	Dimensions		[g]	Art. No.
	d [mm]	s		
L16	39.5	3	24	<a href="#">1617.400</a>
L16	59.5	3	62	<a href="#">1617.500</a>
L16	39.5	4	30	<a href="#">1617.600</a>
L16	59.5	4	79	<a href="#">1617.700</a>
L16	39.5	5	40	<a href="#">1617.800</a>
L16	59.5	5	99	<a href="#">1617.900</a>

### Compliance

#### RoHS compliant

Compliant according to Directive 2011/65/EU and Directive 2015/863.

#### Does not contain SVHC substances

No SVHC substances with more than 0.1% w/w contained - SVHC list [REACH] as of 27.06.2024.

#### Does not contain Proposition 65 substances

No Proposition 65 substances included.

<https://www.P65Warnings.ca.gov/>

#### Free from Conflict Minerals

This product does not contain any substances designated as "conflict minerals" such as tantalum, tin, gold or tungsten from the Democratic Republic of Congo or adjacent countries.