

Pins · with plastic bearing surface

22691.0143



Product Description

Pins with plastic bearing surface can be used as protective supports, stops, and thrust pads. This protects high-quality surfaces from damage.

Material

Insert
• Plastic (PEEK), blue

Threaded bushing
• Stainless steel

Grub Screw
• Stainless steel

Body
• Plastic (PEEK), blue

More information

Further products

- Seating Elements, with plastic bearing surface, orienting
- Pins

Drawing

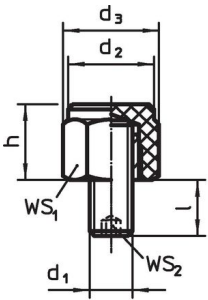

picture 1

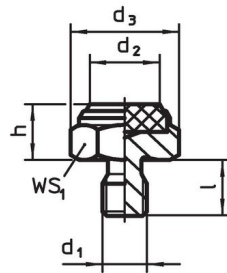

picture 2

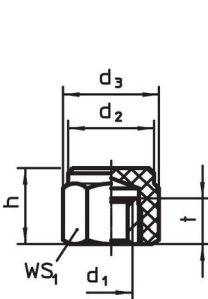

picture 3

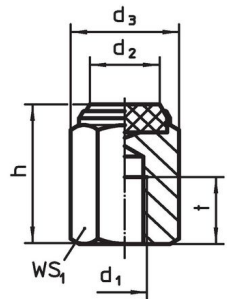

picture 4

Order information

Dimensions					WS ₁	WS ₂	Load capacity for static load max.	Tightening torque max.	Temperature		Weight	Art. No.
h ±0.1	d ₁	d ₂	d ₃	l ±1	[mm]	[mm]			[kN]	[Nm]		
with male thread, body made of plastic (PEEK), bearing surface plain – picture 1												
20	M12	22	25	14	22	6	14	10	-60	250	32	22691.0143

Application example



Compliance

RoHS compliant

Compliant according to Directive 2011/65/EU and Directive 2015/863.

Does not contain SVHC substances

No SVHC substances with more than 0.1% w/w contained - SVHC list [REACH] as of 23.01.2024.

Does not contain Proposition 65 substances

No Proposition 65 substances included.

<https://www.P65Warnings.ca.gov/>

Free from Conflict Minerals

This product does not contain any substances designated as "conflict minerals" such as tantalum, tin, gold or tungsten from the Democratic Republic of Congo or adjacent countries.