

Clamping Bars • length 400 - 700
1585.700



Product Description

Material

- Tool steel, hardened

Drawing

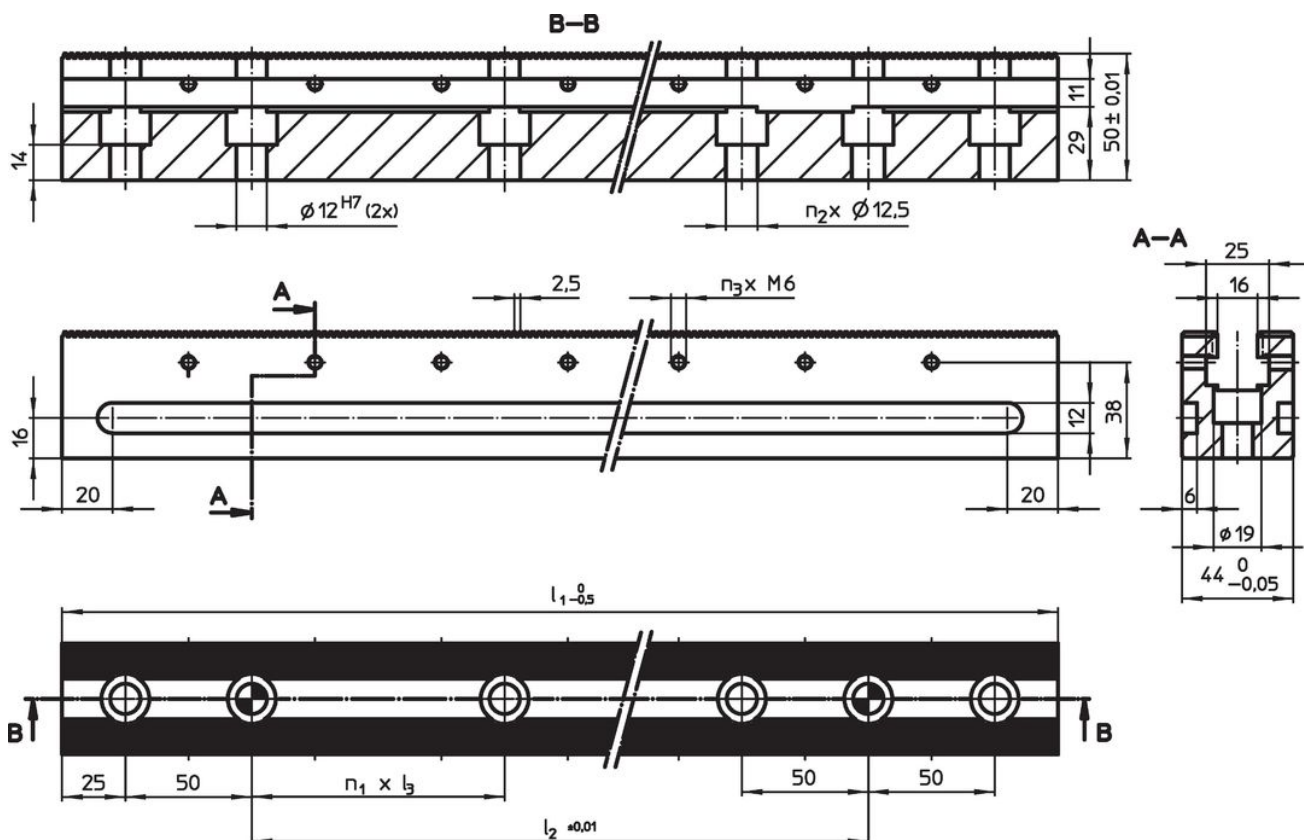

Order information

l ₁	Dimensions			n ₁	Amount			[kg]	Art. No.
	l ₂	l ₃	[mm]		n ₂	n ₃			
700	550	100		5	7	13	8	1585.700	

Accessories

fixing screws for clamping bars	Number locating screws M12 x 45	Number cap screws M12 x 45	[g]	Art. No.
		2	7	453

Compliance

RoHS compliant

Compliant according to Directive 2011/65/EU and Directive 2015/863.

Does not contain SVHC substances

No SVHC substances with more than 0.1% w/w contained - SVHC list [REACH] as of 27.06.2024.

Does not contain Proposition 65 substances

No Proposition 65 substances included.

<https://www.P65Warnings.ca.gov/>

Free from Conflict Minerals

This product does not contain any substances designated as "conflict minerals" such as tantalum, tin, gold or tungsten from the Democratic Republic of Congo or adjacent countries.